

patient commission/configuration ID \_\_\_\_\_

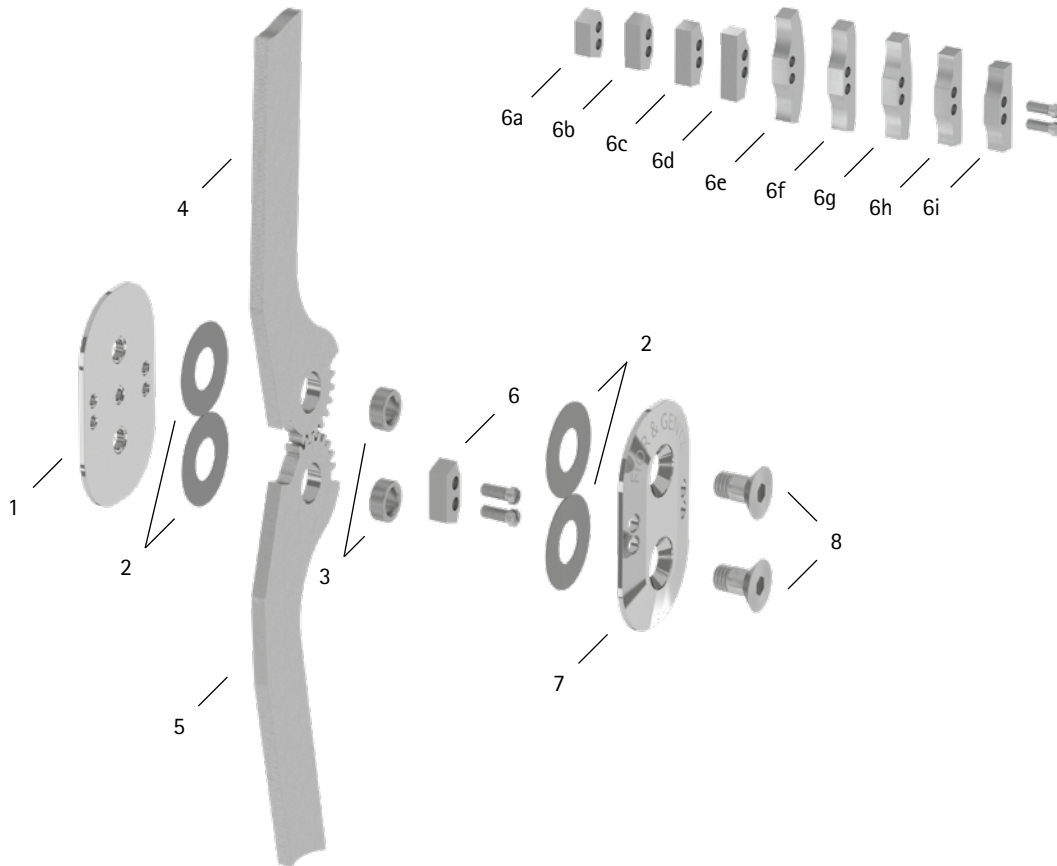

Item	16mm	Description	Potential Problem	Measure	Recommended Inspection, Potential Replacement*	Latest Replacement after
<b>System Joint</b>						
1	SK0250-ST	base plate	wear	replacing	every 6 months	36 months
2	GS2210-050	sliding washer	wear	replacing	every 6 months	18 months
3	BB9665-89	bronze bushing, $\varnothing = 9.6\text{mm}$ , $h = 5.89\text{mm}$	wear	replacing	every 6 months	36 months
3	BB9665-92	bronze bushing, $\varnothing = 9.6\text{mm}$ , $h = 5.92\text{mm}$				
3	BB9665-95	bronze bushing, $\varnothing = 9.6\text{mm}$ , $h = 5.95\text{mm}$				
3	BB9665-98	bronze bushing, $\varnothing = 9.6\text{mm}$ , $h = 5.98\text{mm}$				
4	BK0203-AL	femoral side bar wing, aluminium	wear	replacing	every 6 months	36 months
5	BK0213-AL	tibial side bar wing, aluminium				
6a	BK9051-E000	0° extension stop/80° flexion stop with 2 slotted pan head screws	wear	replacing	every 6 months	if required
6	BK9051-E005	5° extension stop with 2 slotted pan head screws				
6b	BK9051-E010	10° extension stop/70° flexion stop with 2 slotted pan head screws				
6c	BK9051-E020	20° extension stop/60° flexion stop with 2 slotted pan head screws				
6d	BK9051-E030	30° extension stop/50° flexion stop with 2 slotted pan head screws	wear	replacing	every 6 months	not necessary
6e	BK9051-F000	0° flexion stop with 2 slotted pan head screws				
6f	BK9051-F005	5° flexion stop with 2 slotted pan head screws				
6g	BK9051-F010	10° flexion stop with 2 slotted pan head screws				
6h	BK9051-F020	20° flexion stop with 2 slotted pan head screws	wear	replacing	every 6 months	not necessary
6i	BK9051-F030	30° flexion stop with 2 slotted pan head screws				
7	SK0251-ST	cover plate	wear	replacing	every 6 months	36 months
8	SC1016-L13	countersunk flat head screw with hexagon socket and shank	wear	replacing	every 6 months	36 months

\* depending on the assessment of the distributor of the custom-made product regarding the patient's usage behaviour

WP0091-GB-2023-01