

patient commission/configuration ID \_\_\_\_\_

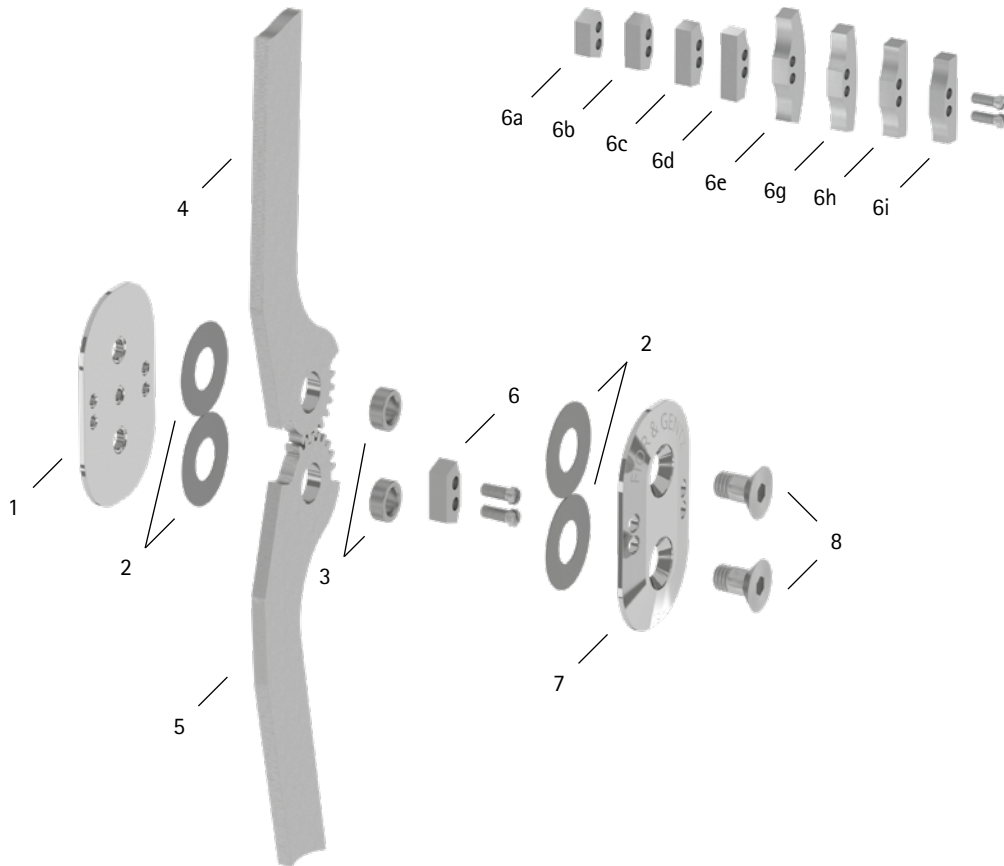

Item	14mm	Description	Potential Problem	Measure	Recommended Inspection, Potential Replacement*	Latest Replacement after
<b>System Joint</b>						
1	KS0150-AL	base plate	wear	replacing	every 6 months	36 months
2	GS1609-050	sliding washer	wear	replacing	every 6 months	18 months
3	BB8554-89	bronze bushing, $\varnothing = 8.5\text{mm}$ , $h = 4.89\text{mm}$	wear	replacing	every 6 months	36 months
3	BB8554-92	bronze bushing, $\varnothing = 8.5\text{mm}$ , $h = 4.92\text{mm}$				
3	BB8554-95	bronze bushing, $\varnothing = 8.5\text{mm}$ , $h = 4.95\text{mm}$				
3	BB8554-98	bronze bushing, $\varnothing = 8.5\text{mm}$ , $h = 4.98\text{mm}$				
4	BK0200-AL	femoral side bar wing, aluminium	wear	replacing	every 6 months	36 months
5	BK0210-AL	tibial side bar wing, aluminium				
6a	KS9502-E000	0° extension stop/100° flexion stop with 2 slotted pan head screws	wear	replacing	every 6 months	if required
6	KS9502-E005	5° extension stop with 2 slotted pan head screws				
6b	KS9502-E010	10° extension stop/90° flexion stop with 2 slotted pan head screws				
6c	KS9502-E020	20° extension stop/60° flexion stop with 2 slotted pan head screws				
6d	KS9502-E030	30° extension stop/70° flexion stop with 2 slotted pan head screws	wear	replacing	every 6 months	not necessary
6e	KS9502-F000	0° flexion stop with 2 slotted pan head screws				
6g	KS9502-F010	10° flexion stop with 2 slotted pan head screws				
6h	KS9502-F020	20° flexion stop with 2 slotted pan head screws				
6i	KS9502-F030	30° flexion stop with 2 slotted pan head screws				
7	KS0151-AL/FG	cover plate	wear	replacing	every 6 months	36 months
8	SC1015-L12	countersunk flat head screw with hexagon socket and shank	wear	replacing	every 6 months	36 months

\* depending on the assessment of the distributor of the custom-made product regarding the patient's usage behaviour

WP0090-GB-2023-01